

RENAISSANCE WORTHINGTON HOTEL
Fort Worth, Texas

Texas Association of Appraisal Districts
February 21-24, 2010

REVISION DATE:
1/29/2010 DB

BOOTH COUNT

Rio Grande Hall
39 - 8'X10's

6-6'rds of 10

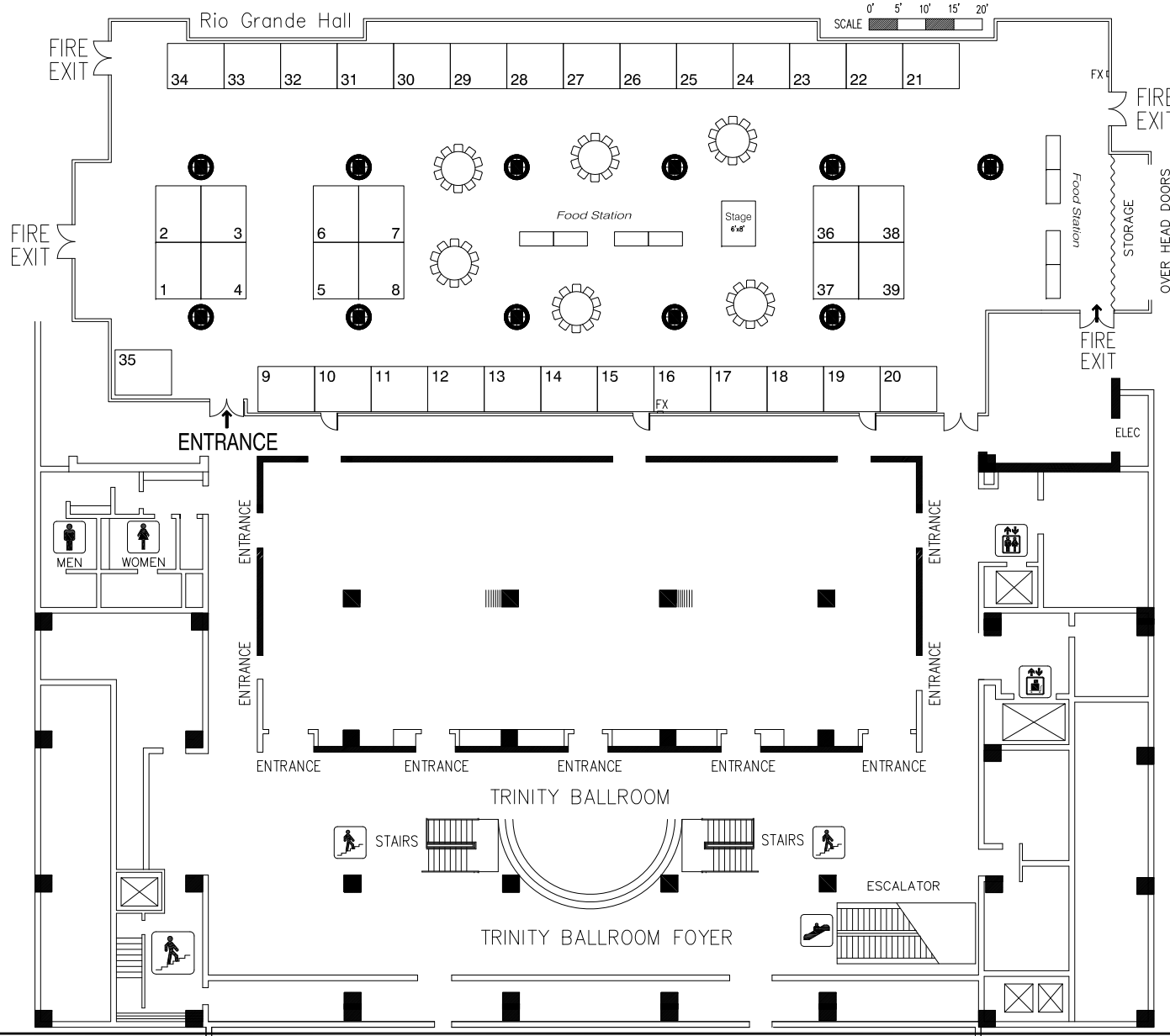

BLDG. LEGEND:

- Column draping around column 1' away bottom of column
- Columns

F R E E M A N

DRAWING STARTED:
7/14/2009 ####
FILE PATH:
N:\2010\TX_Texas SHOWS\Texas Assn Appraisal Districts\Tx Assn Appraisal Dist 0210.dwg

DRAWING NAME:
TX ASSN APPRAISAL DIST 0210
HALL NAME:

JOB NUMBER:

ACCT. EXEC.:
####

NOT TO SCALE

DISCLAIMER

EVERY EFFORT HAS BEEN MADE TO ENSURE THE ACCURACY OF ALL INFORMATION CONTAINED ON THIS FLOORPLAN. HOWEVER NO WARRANTIES, EITHER EXPRESSED OR IMPLIED ARE MADE WITH RESPECT TO THIS FLOORPLAN. IF THE LOCATION OF BUILDING COLUMNS, UTILITIES OR OTHER ARCHITECTURAL COMPONENTS OF THE FACILITY IS A CONSIDERATION IN THE CONSTRUCTION OR USAGE OF AN EXHIBIT, IT IS THE SOLE RESPONSIBILITY OF THE EXHIBITOR TO PHYSICALLY INSPECT THE FACILITY TO VERIFY ALL DIMENSIONS AND LOCATIONS.
COPYRIGHT 2007, FREEMAN CO.
ALL RIGHTS RESERVED.